



SPRAY CHARACTERISTICS

- *Finely atomised hollow cone spray pattern.*
- *Available spray angles of 30°, 45°, 60°, 70°, 80° and 90° at 8,6 Bar.G. pressure.*

CONSTRUCTION AND MATERIALS

Nozzle consists of five basic parts:

- *Nozzle body - Brass or 416 Stainless Steel.*
- *Orifice Disc - 416 Stainless Steel.*
- *Distributor - 416 Stainless Steel.*
- *Retainer - Brass or 416 Stainless Steel.*
- *Strainer - (used up to WDA 14).*
- *Nozzle thread is 9/16" - 24 UNEF.*
- *Adaptors are available with 1/4" Male BSPT and 1/8"/1/4" Female BSPP and can be ordered separately.*

ORDER EXAMPLE

WDA 8,0-70° Stainless Steel = Tip Only.

1/4" Female WDA 12,0-70° Brass = Complete Assembly.

DIMENSIONS AND WEIGHTS

| Assembly Type | Dimensions (mm) | | | | | Weight (g) |
|---------------|-----------------|------|------|------|-------|------------|
| | A Hex | B | C | D | E Hex | |
| 1/8 Female | 15,9 | 52,4 | 38,1 | 14,3 | 18,0 | 82 |
| 1/4 Male | 15,9 | 52,4 | 38,1 | 14,3 | 18,0 | 78 |
| 1/4 Female | 15,9 | 52,4 | 38,1 | 14,3 | 18,0 | 69 |

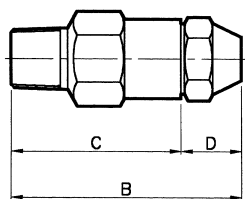

WDA (MALE) ASSEMBLY

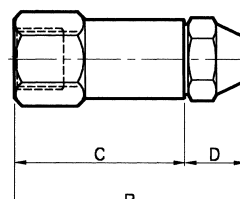

WDA (FEMALE) ASSEMBLY



CAPACITY CHART

Maximum Recommended Pressure: 35 Bar.G.

| NOZZLE NUMBER | APPROX. ORIFICE DIA. (mm) | FLOW RATE IN LITRES/HOUR AT Bar.G. | | | | | | | |
|---------------|---------------------------|------------------------------------|------|------|------|------|------|------|------|
| | | 2 | 3 | 5 | 7 | 10 | 15 | 20 | 35 |
| 0,5 x | 0,21 | - | - | 1,45 | 1,72 | 2,05 | 2,51 | 2,87 | 3,82 |
| 0,75 x | 0,23 | - | - | 2,16 | 2,56 | 3,05 | 3,74 | 4,32 | 5,72 |
| 1,0 | 0,28 | - | - | 2,87 | 3,40 | 4,10 | 5,02 | 5,77 | 7,63 |
| 1,5 | 0,33 | - | - | 4,32 | 5,11 | 6,15 | 7,53 | 8,64 | 11,4 |
| 2,0 | 0,38 | - | - | 5,77 | 6,83 | 8,19 | 10,0 | 11,6 | 15,3 |
| 2,5 | 0,41 | - | - | 7,19 | 8,55 | 10,2 | 12,5 | 14,5 | 19,1 |
| 3,0 | 0,46 | - | - | 8,64 | 10,2 | 12,3 | 15,1 | 17,3 | 22,9 |
| 4,0 | 0,64 | - | 8,69 | 11,5 | 13,7 | 16,4 | 20,1 | 23,1 | 30,5 |
| 5,0 | 0,64 | - | 11,1 | 14,5 | 17,2 | 20,5 | 25,1 | 28,7 | 38,2 |
| 6,0 | 0,74 | - | 14,2 | 17,5 | 20,6 | 24,6 | 30,1 | 34,6 | 45,8 |
| 8,0 | 0,81 | - | 17,8 | 23,1 | 27,5 | 33,1 | 40,6 | 46,2 | 61,1 |
| 10,0 | 0,89 | 17,9 | 22,1 | 28,7 | 34,0 | 41,0 | 50,2 | 57,7 | 76,3 |
| 12,0 | 1,02 | 21,6 | 26,9 | 34,6 | 40,8 | 49,2 | 60,2 | 69,3 | 91,6 |
| 14,0 | 1,02 | 25,3 | 31,2 | 40,2 | 47,7 | 57,0 | 69,8 | 80,8 | 107 |
| 16,0* | 1,17 | 29,1 | 35,6 | 46,2 | 54,6 | 65,2 | 79,8 | 92,4 | 122 |
| 18,0* | 1,32 | 32,8 | 39,9 | 51,8 | 61,4 | 73,4 | 89,9 | 104 | 137 |
| 20,0* | 1,40 | 36,5 | 44,6 | 57,8 | 68,3 | 81,6 | 99,9 | 115 | 153 |
| 24,0* | 1,52 | 45,8 | 53,3 | 69,3 | 82,1 | 98,0 | 120 | 139 | 183 |
| 30,0* | 1,70 | 54,4 | 66,8 | 86,4 | 102 | 123 | 150 | 173 | 229 |
| 35,0* | 1,78 | 64,1 | 78,2 | 101 | 120 | 143 | 175 | 202 | 267 |

x Not available in 30° or 45°.

* These sizes are supplied without strainers.

Contact our Helpline for any special requirements.
Tel: +44 (0) 151 424 6821
Fax: +44 (0) 151 495 1043
e-mail: sales@delavan.co.uk
Web: www.delavan.co.uk

